

TREMLOCK 215 CANTED FASCIA

EXISTING BEVELED WOOD NAILER VERSION

ANSI/SPRI ES-1 TESTED

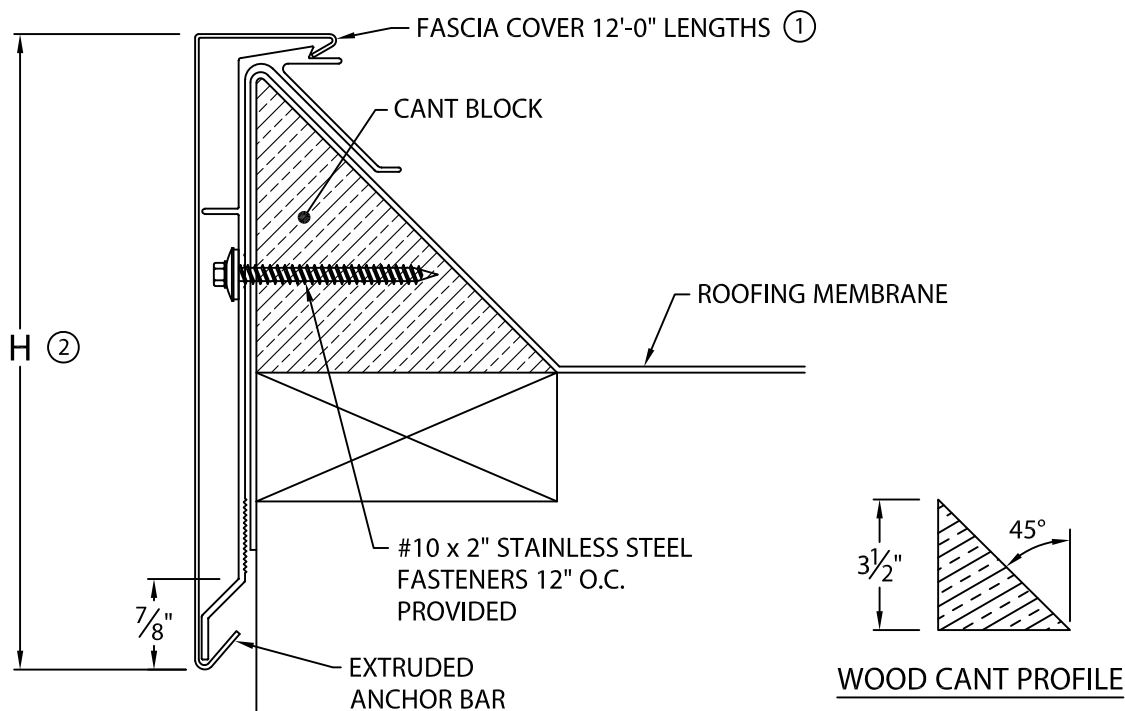

- NOTES:**
- ① FASCIA COVER PROVIDED WITH 3 1/2" WIDE SPLICE PLATES.
 - ② TYPICALLY COVERAGE SHOULD EXTEND A MIN. OF 1 1/2" BELOW WOOD BLOCKING IF APPLICABLE.
 - ③ NOT AVAILABLE IN 24 GA. GALV. STEEL OR .040" ALUMINUM.
 - ④ EXTRUDED BAR VARIES IN DESIGN AT LOWER KICK.

TREMLOCK 215 CANTED FASCIA DIMENSIONS

| PRODUCT ID. NO. | H DIM |
|--------------------------------------|--------|
| <input type="checkbox"/> AEFC-550 ④ | 5 1/2" |
| <input type="checkbox"/> AEFC-750 | 7 1/2" |
| <input type="checkbox"/> AEFC-850 | 8 1/2" |
| <input type="checkbox"/> AEFC-1000 ③ | 10" |

Fabrication will proceed only after receipt of signed print approval.

Print Approval:

Architect and/or contractor shall verify all dimensions, sizes and quantities. All products to be installed in strict accordance with Tremco's printed instructions.

Approved by: _____

Date: _____

MATERIAL:

_____ 24 GA. GALVANIZED STEEL COLOR: _____
 _____ 22 GA. GALVANIZED STEEL FINISH: _____
 _____ .040" ALUMINUM
 _____ .050" ALUMINUM
 _____ .063" ALUMINUM
 _____ OTHER _____

QUANTITIES:

_____ LINEAL FEET 12'-0" LENGTHS
 _____ OUTSIDE MITER(S) @ 90°
 _____ INSIDE MITER(S) @ 90°
 _____ OVERFLOW SCUPPER(S) STYLE _____ A _____ B
 _____ SPILLOUT SCUPPER(S) STYLE _____ A _____ B
 _____ DOWNSPOUT(S) STYLE _____ A _____ B (_____ x _____) DOWNSPOUT SIZE
 A: TAPERED 1 1/2" DROP B: FLAT
 FOR NON-90 MITERS SEE PRINT APPROVAL #60010-29179

PROJECT:

ARCHITECT:

ROOFING CONTRACTOR:

REPRESENTATIVE/DISTRIBUTOR:

TREMCO ROOFING AND BUILDING MAINTENANCE
 3735 GREEN RD; BEACHWOOD, OH 44122
 PHONE: 800-558-2162
 EDGESYSTEMS@TREMCOINC.COM
 WWW.TREMCOROOFING.COM

TREMCO
 ROOFING & BUILDING MAINTENANCE

DATE: 07/18/18

DRN BY: JJC

CKD BY: SAK

SHT.# _____ OF _____

DWG# 60010-29230

A